

OF A PORTION OF TRACT 47 "NILE ORCHARD TRACTS NO. 1" (B-10)
LOCATED IN A PORTION OF THE NW 1/4 OF THE SW 1/4 OF
SECTION 17, T 22 N, R 21 E
WILLAMETTE MERIDIAN
DOUGLAS COUNTY, WASHINGTON

SHEET 2 OF 4

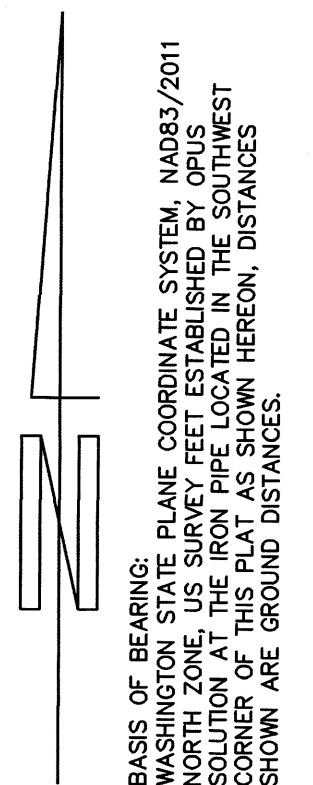

DRAWING FILE: 24452SUB1.DWG DRAWN BY: KLB PROJECT MGR: KLR

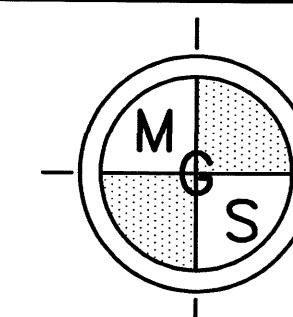

MGS
PASCO, INC.
809 S AUBURN ST
KENNEWICK, WA 99336
509-491-1071