

EASEMENT LINE TABLE		
LINE #	DIRECTION	LENGTH
E-L100	S 87°33'57" W	9.43'
E-L101	S 67°42'29" W	20.00'
E-L102	N 22°17'31" W	72.69'
E-L103	N 22°08'45" W	12.36'
E-L104	N 30°00'35" W	12.19'
E-L105	N 29°57'59" W	12.56'
E-L106	N 30°00'26" W	12.02'
E-L107	N 29°56'39" W	12.61'
E-L108	N 49°01'14" W	12.46'
E-L109	N 64°10'20" W	14.15'
E-L110	S 6°28'47" E	23.24'
E-L111	S 28°22'54" E	128.39'
E-L119	N 4°19'54" W	10.00'
E-L121	S 6°45'10" E	10.00'
E-L125	N 39°13'09" W	20.00'
E-L127	S 13°28'15" E	20.00'
E-L132	S 4°08'08" E	30.87'
E-L135	N 89°57'23" W	8.72'
E-L140	S 70°17'59" W	32.31'
E-L141	N 47°51'36" W	10.07'
E-L142	N 4°28'25" W	62.59'
E-L143	N 0°02'57" E	113.03'
E-L144	S 0°06'58" W	1778.39'
E-L200	N 72°43'51" E	159.41'
E-L201	N 47°36'23" E	15.88'
E-L207	N 4°08'08" W	69.52'
E-L208	N 4°08'08" W	0.30'
E-L209	N 4°08'08" W	14.68'
E-L210	N 4°08'08" W	9.97'
E-L211	N 85°51'52" E	6.83'
E-L212	S 85°51'52" W	5.28'
E-L213	N 85°51'52" E	10.22'
E-L214	N 85°51'52" E	10.44'
E-L215	S 22°20'50" W	53.00'
E-L216	S 86°58'10" W	68.50'
E-L217	S 33°42'54" E	61.66'
E-L218	N 82°06'03" E	61.66'
E-L219	N 0°35'16" W	68.50'
E-L220	N 39°20'09" E	43.50'

EASEMENT CURVE TABLE					
CURVE	RADIUS	DELTA	LENGTH	COURSE	CHORD
E-C101	176.00'	2°26'32"	7.50'	S 79°58'46" W	7.50'
E-C102	176.00'	2°26'32"	7.50'	S 82°25'18" W	7.50'
E-C103	293.00'	1°22'08"	7.00'	S 70°56'35" W	7.00'
E-C104	293.00'	1°33'53"	8.00'	S 69°28'34" W	8.00'
E-C105	293.00'	1°28'00"	7.50'	S 43°15'46" W	7.50'
E-C106	293.00'	1°28'00"	7.50'	S 41°47'45" W	7.50'
E-C107	327.00'	1°18'51"	7.50'	S 62°30'16" W	7.50'
E-C108	327.00'	1°18'51"	7.50'	S 63°49'07" W	7.50'
E-C109	197.00'	2°10'55"	7.50'	S 79°32'18" W	7.50'
E-C110	197.00'	2°10'55"	7.50'	S 77°21'23" W	7.50'
E-C111	197.00'	2°10'55"	7.50'	S 25°57'56" W	7.50'
E-C112	197.00'	2°10'55"	7.50'	S 23°47'01" W	7.50'
E-C113	541.00'	1°03'33"	10.00'	S 61°18'11" E	10.00'
E-C114	541.00'	0°31'46"	5.00'	S 5°30'32" E	5.00'
E-C115	75.50'	10°27'00"	13.77'	S 55°17'51" W	13.75'
E-C123	20.00'	133°37'45"	46.65'	S 7°26'51" E	36.77'
E-C124	124.00'	33°50'12"	73.23'	S 76°17'07" W	72.17'
E-C125	124.00'	1°16'31"	2.76'	N 86°09'31" W	2.76'
E-C126	345.00'	1°12'09"	7.24'	N 86°07'20" W	7.24'
E-C127	345.00'	7°36'29"	45.81'	S 89°28'21" W	45.78'
E-C128	355.00'	2°25'16"	15.00'	S 84°27'28" W	15.00'
E-C129	345.00'	38°00'48"	228.89'	S 64°14'26" W	224.72'
E-C131	345.00'	7°22'21"	44.39'	S 41°32'51" W	44.36'
E-C132	275.00'	12°55'11"	62.01'	S 44°19'16" W	61.88'
E-C134	255.00'	15°23'47"	68.52'	S 58°28'45" W	68.32'
E-C135	255.00'	2°34'47"	11.48'	S 67°28'02" W	11.48'
E-C136	255.00'	7°46'20"	34.59'	S 72°38'35" W	34.56'
E-C137	275.00'	11°23'04"	54.64'	S 82°13'17" W	54.55'
E-C138	249.00'	101°19'15"	440.33'	S 37°15'12" W	385.15'
E-C139	489.00'	5°31'41"	47.18'	S 10°38'35" E	47.16'
E-C140	489.00'	3°44'37"	31.95'	S 6°00'26" E	31.94'
E-C141	61.66'	64°11'03"	69.08'	S 24°11'35" W	65.52'
E-C142	25.50'	17°29'37"	7.79'	S 81°17'48" W	7.76'

Sheet 7 OF 8	Job No : 20122	Drawn Date
	Issue	3.25.2025
	FINAL MYLAR	

Rocky Pond Resort Residences LLC  
 116 Orchard Place  
 Orondo, Wa. 98843

**ROCKY POND RESORT RESIDENCES**  
 SUBDIVISION P-2022-08  
 A COMMON INTEREST PLAT COMMUNITY  
 T. 26 N. R. 21 E.W.M.  
 PORTION OF GOVERNMENT LOT 4  
 SECTION 12  
 DOUGLAS COUNTY, WASHINGTON

\$458.50  
 A.F.N. 3274353

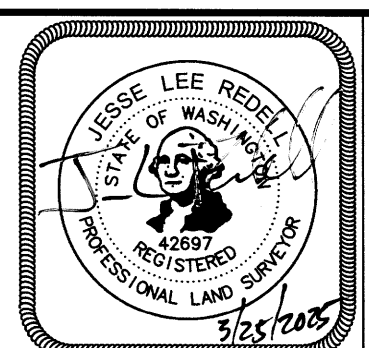

**COMPLETE DESIGN INC.**  
 "Construction Design Specialists"  
 PO Box 1914  
 Wenatchee, WA. 98807  
 www.completedesign.cc  
 contact@completedesign.cc  
 509.662.3699